

# Saint Roch

Cast Iron Boilers

## OPTI MAJOR

The OPTIMAJOR Boiler is a European design, light commercial, 3-pass boiler. OPTIMAJOR can be fired with oil or gas, making it a versatile choice for many applications.

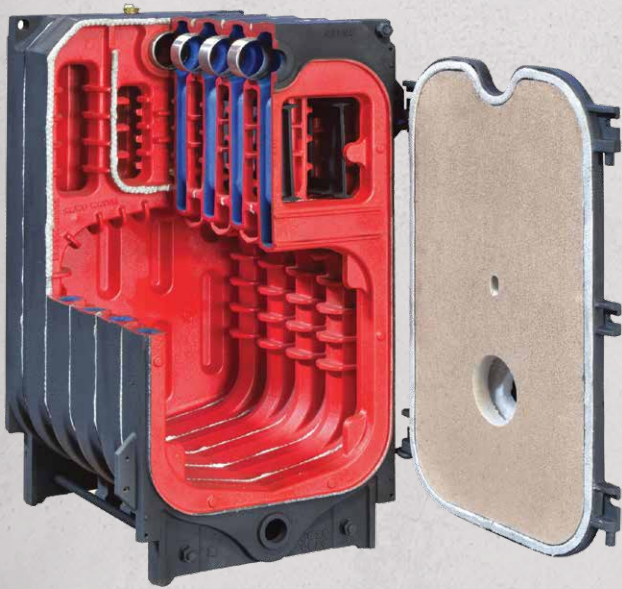

**LIGHT COMMERCIAL 3-PASS  
CAST IRON BOILER**





## THE SAINT ROCH "OPTIMAJOR" SERIES

The OPTIMAJOR cast iron sectional boiler is engineered to ensure high efficiency and boiler safety. The combustion chamber is equipped with fins ensuring exposure to burner heat, preventing the formation of dangerous inner stresses and reducing noise levels. The sections are connected with steel push nipples and are designed with grooves on both sides, where a refractory cord is fitted. The refractory cord adapts to the expansion and shrinking of the heating elements. The OPTIMAJOR boilers use a standard Hydrolevel 3250Plus control that is remote mounted.



The OPTIMAJOR has a full hinged cast iron door that pivots either left or right allowing complete access to the entire boiler heat exchanger and combustion chamber which makes cleaning the boiler an easy task.

Product Code	# of Sections	Heating Capacity (BTU/HR)	Net Output (BTU/HR)	Length (Inch)	Water Content (gal)	Weight (Lbs)	Efficiency (%)
OPTI GLP 6	6	267,000	232,000	29"	13	871	87
OPTI GLP 8	8	377,000	328,000	37"	17	1091	87
OPTI GLP 10	10	479,000	417,000	45"	20	1312	87
OPTI GLP 12	12	588,000	512,000	53"	25	1532	87
OPTI GLP 14	14	667,000	580,000	61"	29	1752	87

- ASME Certified
- Reverse Flame Combustion Chamber
- 3-Pass boiler w/cast iron baffles
- Insulated jacket, full swing cast iron door
- NPT Tappings

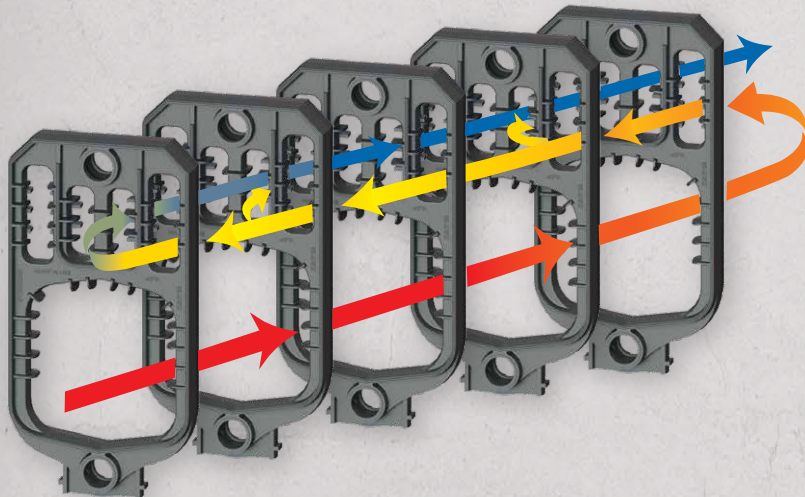
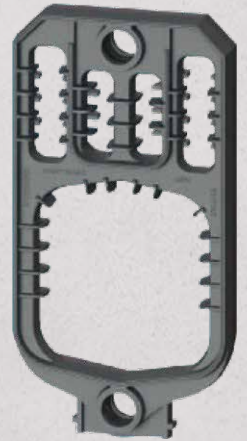

The OPTIMAJOR is equipped with 4 turbulators in the flue ways to slow the smoke cycle, increase element exposure to heat and facilitate cleaning. This increases efficiency and lowers energy consumption.

